

Getting started with
Première utilisation
Logitech® Wireless Desktop MK710



Contents

English	Setup, 3	Features and troubleshooting, 8
Español	Instalación, 3	Características y resolución de problemas, 19
Français	Installation, 3	Fonctions et dépannage, 30
Português	Programa de instalação, 3	Recursos e solução de problemas, 41

www.logitech.com/support, 55



MK700



M705



1

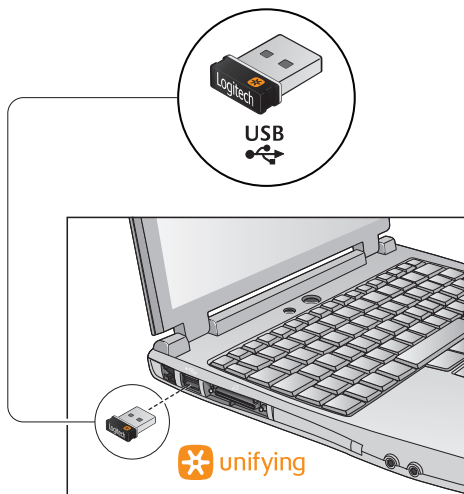

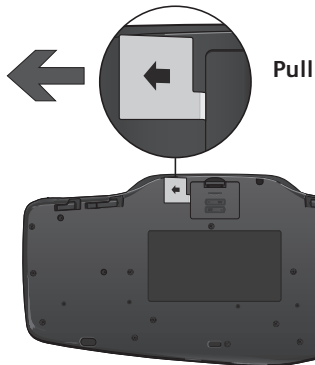
Español TIRAR**Français** TIRER**Português** PUXAR**2**

3

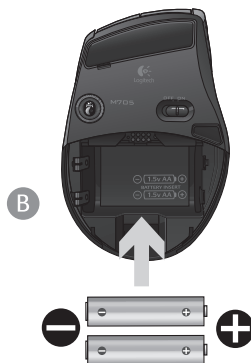
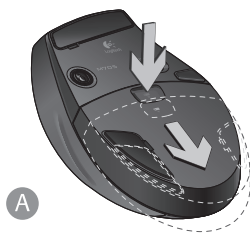



English

Your Keyboard and mouse are now ready for use. Install the Logitech® SetPoint™ Software to do the following:

- Enable some of the F-keys and customize up to 14 keys on the keyboard
- Enable the Mute icon on the LCD
- Enable the tilt wheel and customize up to 6 buttons on the mouse

Español

Ya puedes usar el teclado y mouse. Instala el software Logitech® SetPoint™ para:

- Activar algunas de las teclas F y personalizar hasta 14 botones en el teclado
- Activar el icono de silencio en la pantalla LCD
- Activar el botón rueda y personalizar hasta 6 botones en el mouse

Français

Votre ensemble clavier et souris est maintenant prêt à l'emploi. Installez le logiciel Logitech® SetPoint™ pour effectuer les actions suivantes:

- activer les touches F et personnaliser jusqu'à 14 touches du clavier;
- activer l'icône de sourdine sur l'écran LCD;
- activer la roulette multidirectionnelle et personnaliser jusqu'à six boutons de la souris.

Português

O teclado e o mouse estão prontos para ser usados. Instale o Logitech® SetPoint™ Software para fazer o seguinte:

- Ativar algumas teclas F e personalizar até 14 teclas no teclado
- Ativar o ícone de sem som no LCD
- Ativar a roda de inclinação e personalizar até 6 botões no mouse

Keyboard features: F-key usage



User-friendly enhanced F-keys let you launch applications easily. To use the enhanced functions (yellow icons), first press and hold the **FN** key; second, press the F-key you want to use.

Tip In the software settings, you can invert the FN mode if you prefer to access directly the enhanced functions without having to press the FN key.

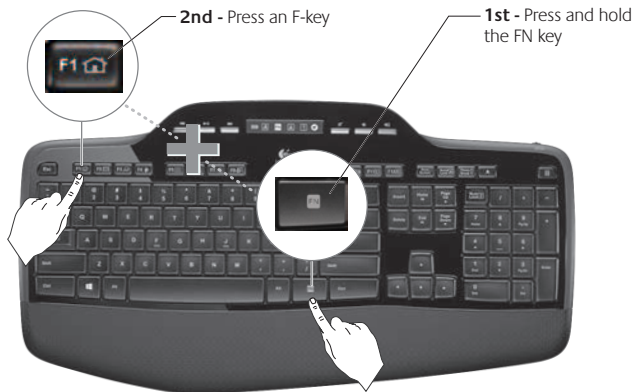

Keyboard features: F-keys and more



1. Internet zone

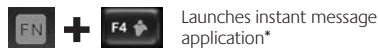
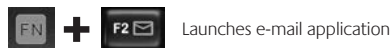

2. Convenience zone



3. Productivity zone

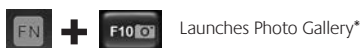
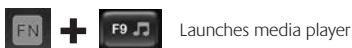

4. Context menu



5. PC sleep mode

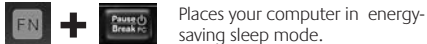

6. Eject button*



* Logitech® SetPoint™ Software installation is required.

Keyboard features: Media keys and status icons



7. Multimedia navigation



Back/previous track



Play/pause



Forward/next track

8. LCD Dashboard icon status



Battery status indicator (see Battery management for more information)

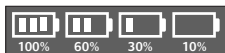

Caps lock on



FN on



Scroll lock on



Num lock on



Mute on*

* Logitech® SetPoint™ Software installation is required.

9. Volume control



Mute



Volume down



Volume up

10. Keyboard off/on switch



11. Launches calculator



Mouse features

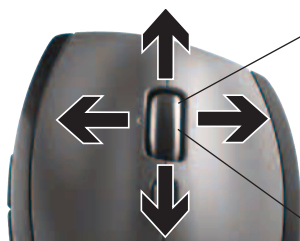

Zoom

Press scroll wheel to zoom.

MicroGear precision scroll wheel

Tilt wheel for side-to-side (horizontal) scrolling through spreadsheets or wide documents. The scroll wheel doubles as a middle button. Press down to use and press again to release.



Scroll toggle

With the flick of a switch, change between precision (click-to-click) scrolling and hyper-fast scrolling.

Precision scrolling

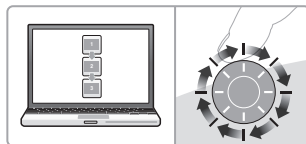

Use click-to-click mode to navigate lists or slides.

Hyper-fast scrolling

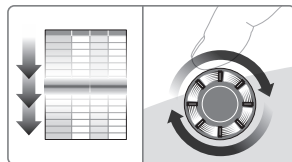

The wheel spins freely, allowing you to fly through long documents and Web pages.

More mouse features

1. **Back and Forward Buttons*** – Press to flip between web pages.
2. **Application Switcher*** – Press rubber grip to switch between applications.
3. **Battery Indicator Light** – Turns red when a couple weeks of battery life remain.
4. **On/Off Switch** – Slide to turn mouse on and off.
5. **Battery Door Release** – Press where indicated and slide door off mouse. Reduce weight by installing a single battery.
6. **Receiver Storage Space Inside the Mouse**

* Application Switcher and side-to-side scrolling require Logitech software. Depending on your operating system, the back, forward, and middle buttons may also require Logitech software.



Battery management

Your keyboard and mouse have up to three years of battery life.*

Battery sleep mode

Did you know that your keyboard and mouse go into sleep mode after you stop using them for a few minutes? This feature helps limit battery usage and eliminates the need to keep switching your devices on and off. Both your keyboard and mouse are up and running immediately once you begin using them again.

How to check the battery level for the keyboard

The battery icon on the keyboard LCD shows the current battery level for the keyboard. As the battery level decreases, the battery icon shows how much battery power remains, as shown in the image to the right.

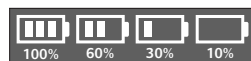

How to check the battery level for the mouse

Option 1: Turn the mouse **off** then back **on** using the On/Off switch on the mouse bottom. If the LED on top of the mouse glows green for 10 seconds, the batteries are good. If the LED blinks red, the battery level has dropped to 10% and you have only a few days of battery power left.

Option 2: Launch the SetPoint Software, and click the Mouse Battery tab to see the current battery level of the mouse.



* Battery life varies with usage and computing conditions. Heavy usage usually results in shorter battery life.

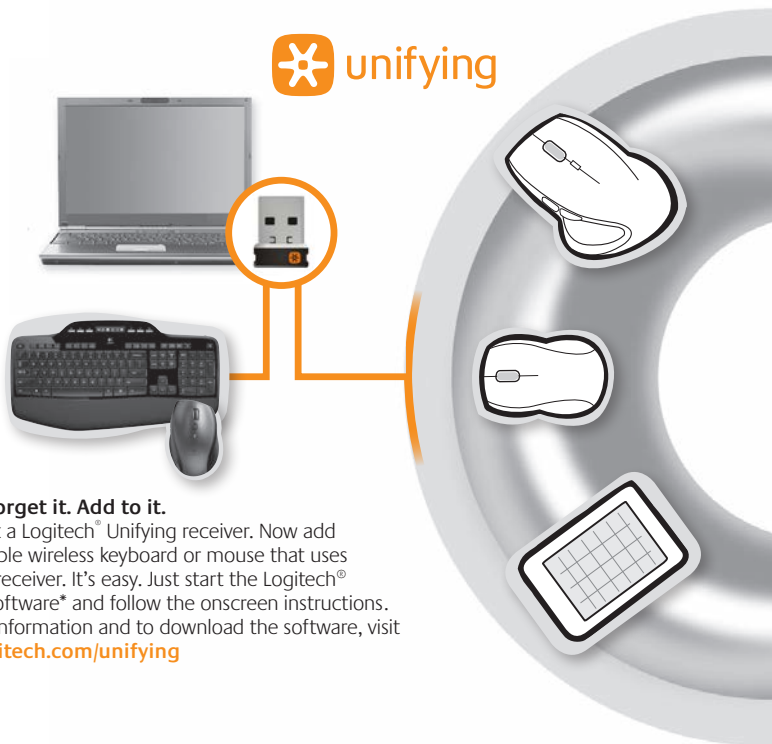

Plug it. Forget it. Add to it.

You've got a Logitech® Unifying receiver. Now add a compatible wireless keyboard or mouse that uses the same receiver. It's easy. Just start the Logitech® Unifying software* and follow the onscreen instructions. For more information and to download the software, visit

www.logitech.com/unifying

Troubleshooting

Keyboard and mouse are not working

- ✓ **Check the USB connection.** Also, try changing USB ports.
- ✓ **Move closer?** Try moving the keyboard and mouse closer to the Unifying receiver, or plug the Unifying receiver into the receiver extender cable to bring it closer to the keyboard and mouse.
- ✓ **Check battery installation.** Also check the battery power of each device.
(See *Battery management* for more information.)

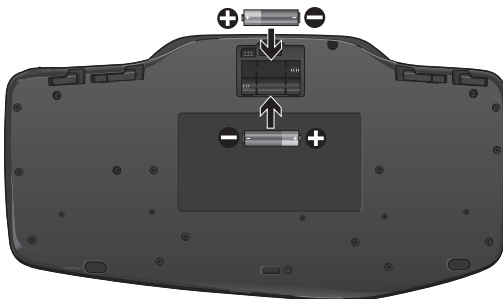

On the mouse bottom, slide the On/Off switch right to turn on the mouse. The Battery LED on the mouse top case should light green for 10 seconds. (See *Battery management* for more information.)



Troubleshooting

- ✓ **Are you experiencing slow or jerky cursor movement?**
Try the mouse on a different surface (e.g., deep, dark surfaces may affect how the cursor moves on the computer screen).
- ✓ **Is the keyboard turned on?** Slide the keyboard Off/On switch to the **On** position, as shown in the image below. The keyboard Status icons should light up.

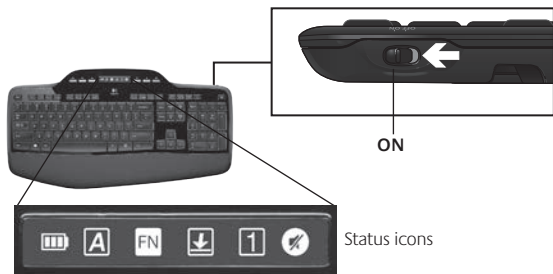
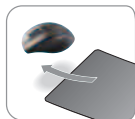

- ✓ **Re-establish the connection.** Use the Unifying software to reset the connection between the keyboard/mouse and Unifying receiver. Refer to the Unifying section in this guide for more information.
- ✓ **Install Logitech SetPoint Software** to customize your keyboard and mouse in order to fully take advantage of all features. logitech.com/downloads

For additional help, refer to the Customer Support telephone numbers.
Also visit **www.logitech.com/comfort** for more information about using your product, and for ergonomics.