



**COMPACT TENSIONED** is a motorized screen that incorporates a tab guide cable system which maintains tension on the cloth in order to get the screen surface perfectly flat.

This product has been specifically studied for the niche of the Home Theatre market, so it is the right solution for the most demanding requests.

It is professionally masked with black curved side borders and a black top border of 30 cm.

Available in 4:3, 16:9 and 16:10 formats or *bespoke sizes*.



**False ceiling trim kit**  
(optional - for details see p. 52)



**White side covers**  
(optional)



n.2  
Wall/Ceiling  
brackets



n.1  
On/off  
switcher

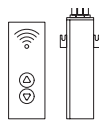

Kit RF Remote  
control with  
external  
receiver



Interface  
switch 12 volt



Multiple  
control  
interface set



Interface  
RS485



Low voltage  
contact  
interface



Nm 9  
Rpm 26



Nm 7  
Rpm 18

Faster  
motor

Extremely  
quiet motor

**INCLUDED**

**OPTIONAL** pag 70-71



**DROP OF  
PROJECTION  
CLOTH**  
STANDARD

**FRONT DROP OF  
PROJECTION  
CLOTH**  
(optional)

## WALL-CEILING BRACKET

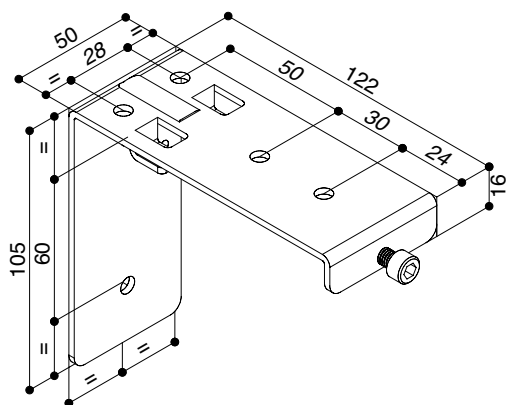

## HOUSING DIMENSIONS

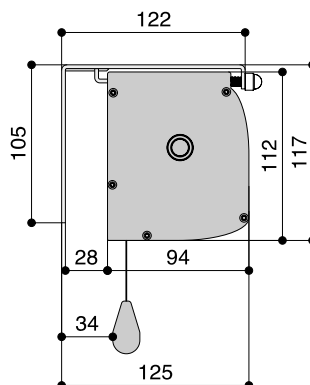

## WALL MOUNTING

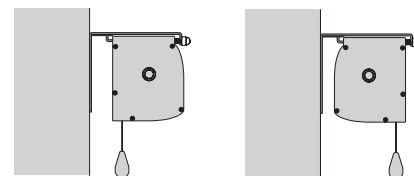

## CEILING MOUNTING

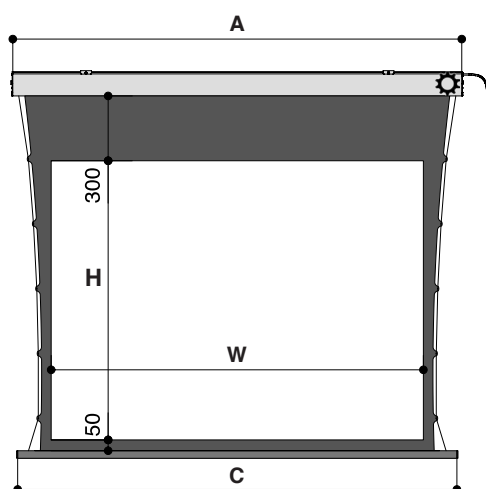
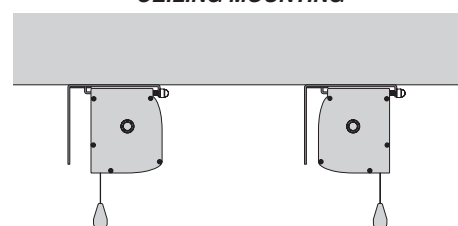

## TECHNICAL SPECIFICATIONS

- Silent motor system provides a smooth and quiet operation
  - Power: **6 Nm**
  - Speed: **17 rpm**
  - Power supply: **230V / 50 Hz**
  - Consumption: **137 W**
  - Certification: **IMQ**
- Totally manufactured from aluminium
- Smart design and easy to install
- Housing dimensions: 94x112 mm. (DxH)
- Housing painted with white epoxy powders (RAL 9010)
- Two universal mounting brackets either for ceiling or for wall included
- On/off switcher included
- Power cable located at the **right** side of the screen housing seen from the front
- Flame-retardant projection surfaces
- Side black borders of 5 cm. (in the narrowest point), black bottom border of 5 cm., black top drop of 30 cm. and black dowel bar: height 35 mm. depth 20 mm.
- Hour-shape glass tensioning system to provide perfect flatness
- **Screen housing available in different colours** (optional)

## DIMENSIONS measures in cm

4:3 Ratio Viewing area (WxH)	16:10 Ratio Viewing area (WxH)	16:9 Ratio Viewing area (WxH)	Overall dimensions A - C	Approx. net weight (Kg)
160 x 120	160 x 100	160 x 90	198 - 194	15
180 x 135	180 x 112	180 x 101	218 - 214	17
200 x 150	200 x 125	200 x 112	238 - 234	19
220 x 165	220 x 137	220 x 124	258 - 254	20
250 x 190	250 x 156	250 x 140	288 - 284	22

## PROJECTION CLOTHS

Front projection surfaces	Gain	Rear projection surfaces <i>**no black borders**</i>	Gain
White	1.2	Rear Plus	1.1
Matte White	1.2	Front Rear	0.9
Lumi Grey	0.8		
Microperforated	1.1		
Lumi Grey Microperforated	0.8		
Cinesound*	0.7		
Pure KS	1.1		
Pure Matte KS	1.1		
Silver Blast*	1.3		
Bright Contrast 3D 0.8*	0.8		

\*Limited in height

**Warranty:** 5 years on the motor - 24 months on the other components

**ENGINEERED LIKE NO OTHER SCREEN IN THE WORLD**  
[www.screenint.com](http://www.screenint.com)

